

Ruskin Road, Belvedere £1,500 PCM

AVAILABLE END OF JUNE (subject to successful references)

Parris Residential are delighted to offer this spacious two bedroom, two bathroom ground floor apartment with two tandem covered parking spaces. The property has the benefit of a private outside patio area leading from the living room. The kitchen also has appliances which are included. The development itself is situated at the end of a cul de sac with panoramic views over the surrounding area. Your inspection is highly recommended.

EPC: C | Council Tax: Bexley - Band C | Security Deposit: £1730.00 | Holding Deposit: £346.00
Bills not Included



entrance hall

lounge & kitchen 25'6 x 10'9 widening to 15'5 (7.77m x 3.28m widening to 4.70m)

bedroom one 12'4 x 11'4 (3.76m x 3.45m)

en-suite shower room & W.C. 8'8 x 3'10 (2.64m x 1.17m)

bedroom two 12'7 x 10'1 (3.84m x 3.07m)

bathroom 8'8 x 6'5 (2.64m x 1.96m)

covered parking space for 2 vehicles

GROUND FLOOR

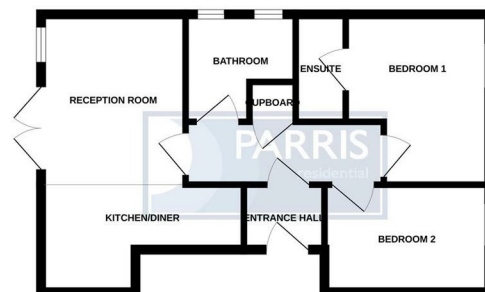

These particulars are believed to be correct but their accuracy is not guaranteed and they do not constitute an offer or form part of any contract. Great care is taken when measuring but measurements should not always be relied upon for ordering carpets, equipment etc. Parris Residential have not tested any included equipment or central heating system checked mentioned in these particulars and purchasers are advised to satisfy themselves as to their working order and condition. Where floor plans are shown they are for illustration and guidance purposes only.